

- CONNECT (N) 4" SANITARY SEWER BELOW SLAB TO (E) SANITARY SEWER LINE. (FIELD VERIFY EXACT SIZE AND LOCATION - MIN. 4")
- CONNECT (N) 1/2" COLD WATER TO (E) COLD WATER LINE. (FIELD VERIFY EXACT SIZE AND LOCATION - MIN. 1/2")
- P.O.C. OF (N) VENT TO (E) VENT LINE. (FIELD VERIFY EXACT SIZE AND LOCATION - MIN. 2")
- 1" CONDENSATE DRAIN AND SECONDARY DRAIN PAN DRAIN FROM AHU-1 TO FLOOR DRAIN WITH FUNNEL. REFER TO DETAIL J ON SHEET P03.1.
- PLUMBING CONTRACTOR SHALL PROVIDE AND INSTALL REMOTE CHILLER FOR THE DRINKING FOUNTAIN. MOUNT CHILLER ABOVE CEILING AND MAINTAIN MANUFACTURER'S RECOMMENDED CLEARANCES FOR EQUIPMENT MAINTENANCE. FIELD VERIFY EXACT LOCATION AND REQUIREMENTS. ALSO FIELD VERIFY MOUNTING HEIGHT WITH CONSTRUCTION MANAGER. SEE PLUMBING FIXTURE SCHEDULE ON SHEET P01.1 FOR FURTHER INFORMATION.
- PIPE HOT WATER HEATER DRAIN PAN AND P/T RELIEF VALVE TO FLOOR DRAIN WITH FUNNEL ADJACENT TO MOP SINK.

GC TO PROVIDE WRITTEN REPORT TO LSD&C PM ON CONDITION OF EXISTING SEWER TIE-IN REGARDING SLOPE AND FLOW.
• SCOPE WITH CAMERA PRIOR TO CONNECTION
• DO NOT CONNECT WITHOUT LSD&C PM AUTHORIZATION IF SPECS NOT MET

PLUMBING AND FIRE SPRINKLER HEAD
PLAN KEYNOTES

NTS

D
11/11/11

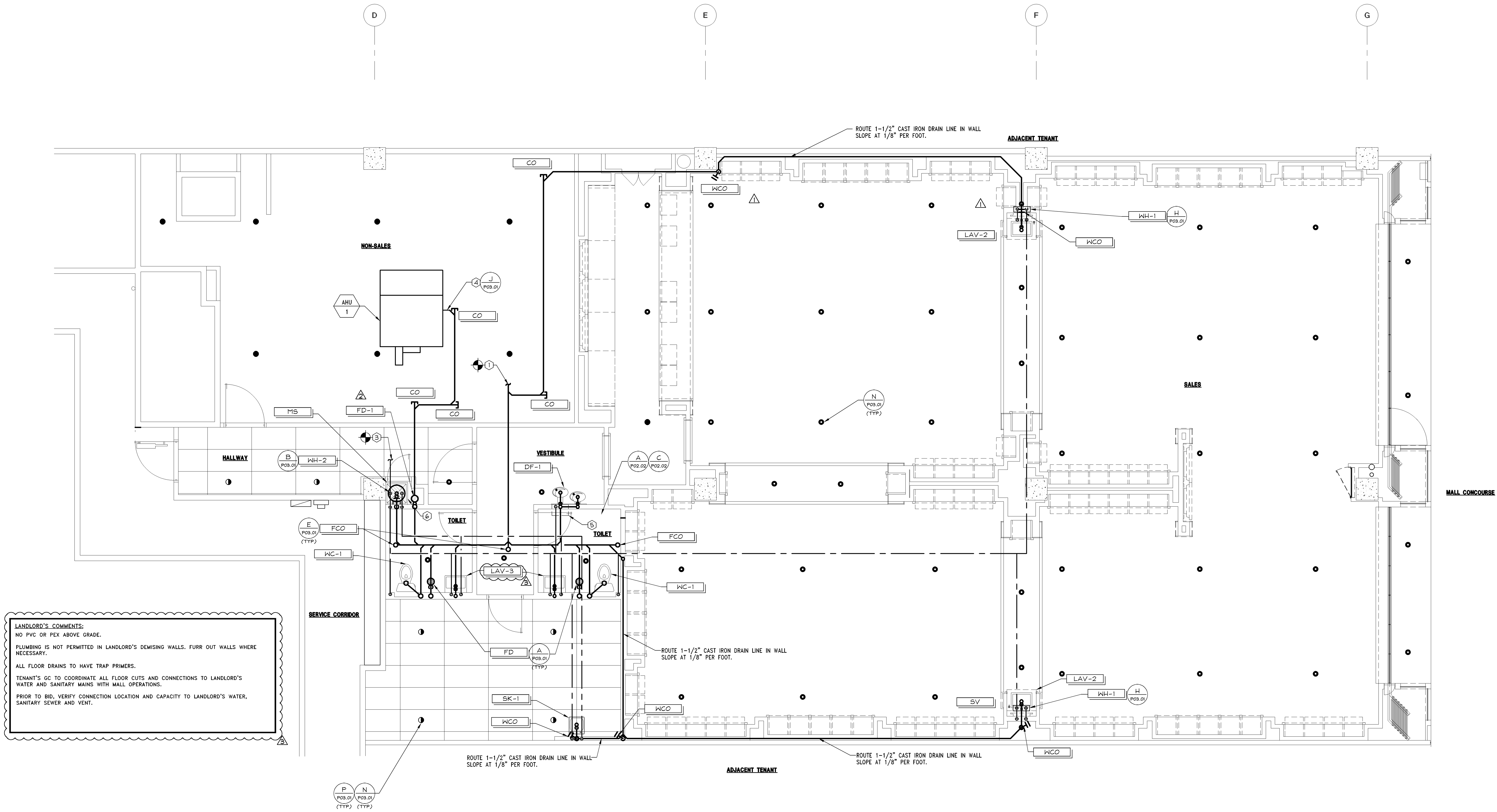

LANDLORD'S COMMENTS:
NO PVC OR PEX ABOVE GRADE.
PLUMBING IS NOT PERMITTED IN LANDLORD'S DEMISING WALLS. FURR OUT WALLS WHERE NECESSARY.
ALL FLOOR DRAINS TO HAVE TRAP PRIMERS.
TENANT'S GC TO COORDINATE ALL FLOOR CUTS AND CONNECTIONS TO LANDLORD'S WATER AND SANITARY MAINS WITH MALL OPERATIONS.
PRIOR TO BID, VERIFY CONNECTION LOCATION AND CAPACITY TO LANDLORD'S WATER, SANITARY SEWER AND VENT.

VERIFY ALL FIELD CONDITIONS PRIOR TO BID

